



Serie

S - 350 EUR

Especificaciones Técnicas

Carpintería practicable

Cámara Europea

Junta abierta con Junta Central

Sección de Marco 40 mm.

Sección de Hoja 47 mm.

Galce de vidrio de 7,5 a 34 mm.

Peso Máximo por : Hoja Practicable : **120 Kg.**⁽¹⁾

Hoja Oscilo- Batiente : **130 Kg.**⁽¹⁾

Hoja Oscilo- Batiente con opción de Herraje Oculto

Medidas Máximas por Hoja para todas las aperturas :

1700 mm. x 2500 mm.⁽¹⁾

(1) Consultar rangos de aplicación con nuestro Dpto. Técnico Comercial

Clasificación obtenida

Permeabilidad al aire*	CLASE	4
Estanqueidad al agua*	CLASE	8A
Resistencia al viento*	CLASE	C4
Transmitancia térmica**	3,8	W(m ² K)
Aislamiento Acústico***	38	(-1;-5)dB

* Ventana de 2 hojas de 1230 x 1480 mm .

** Ventana de 2 hojas de 1480 x 2180 mm ; Vidrio 4-8-4

*** Ventana de 2 hojas de 1230 x 1480 mm ; Vidrio Rw: 40 (-2;-6)dB

Posibilidades de Apertura

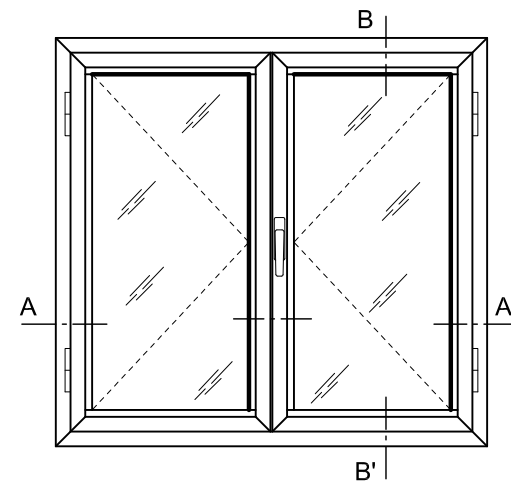
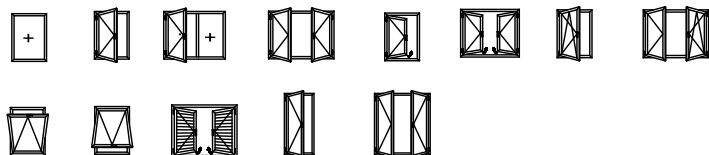

VENTANA 2 HOJAS PRACTICABLES

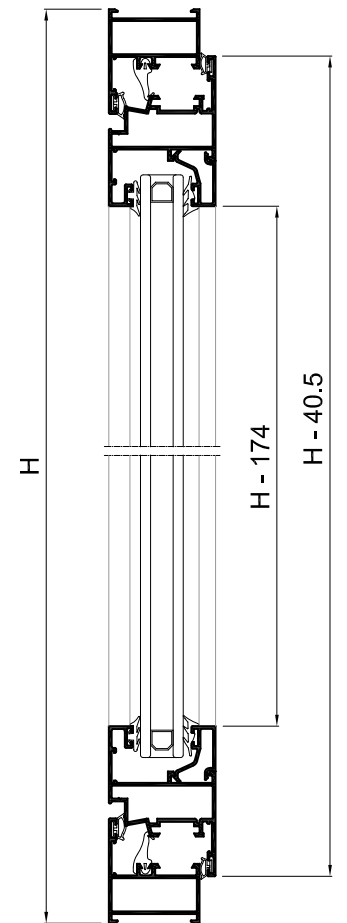

Sección B-B'

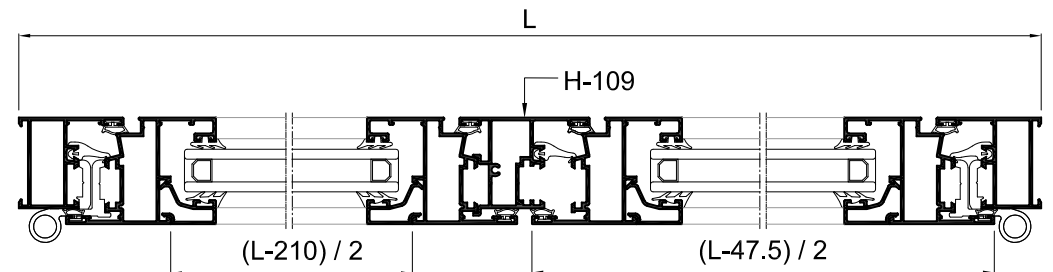

Sección A-A'

* **Tabla de Junquillos 1 (Altura 20 mm)**

Perfiles

S - 350 EUR

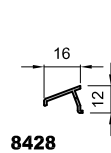
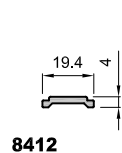
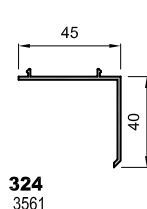
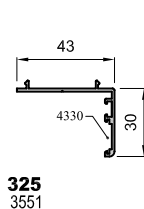
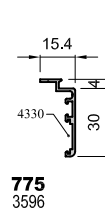
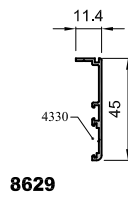
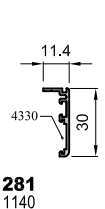
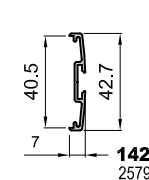
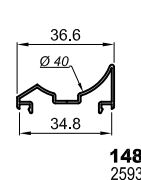
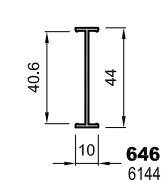
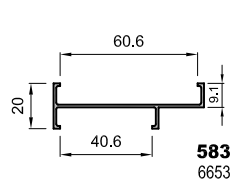
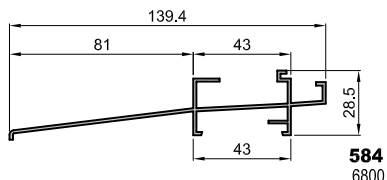
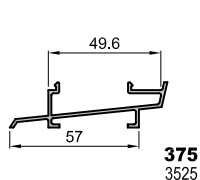
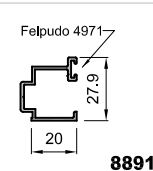
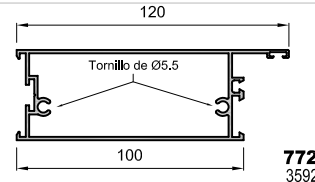
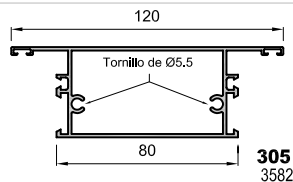
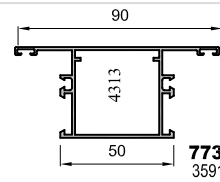
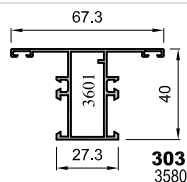
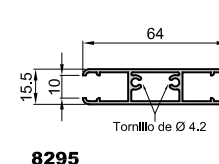
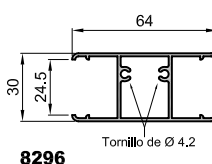
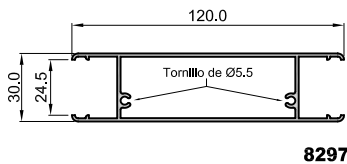
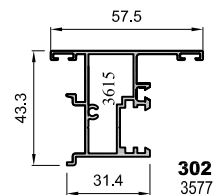
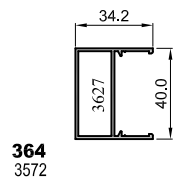
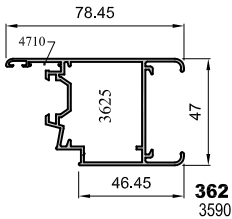
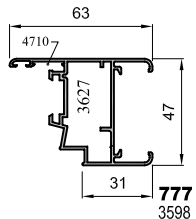
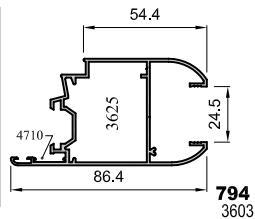
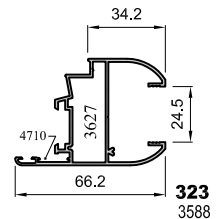
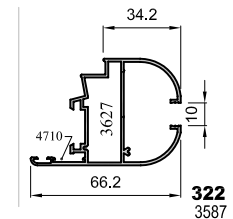
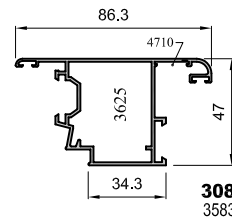
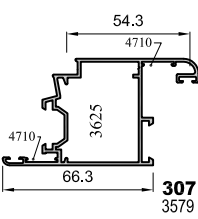
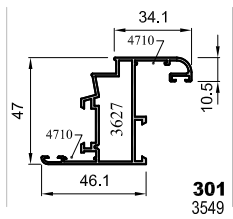
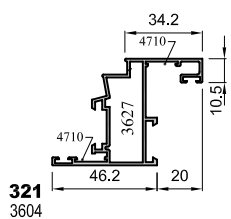
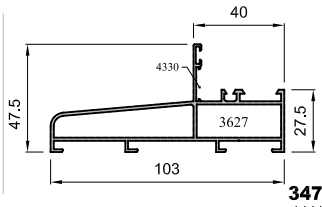
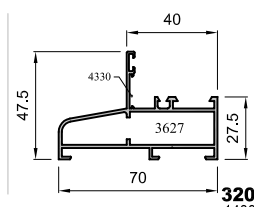
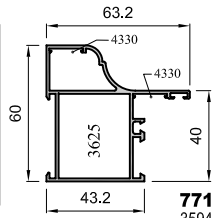
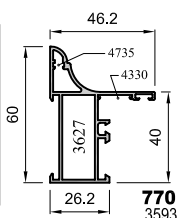
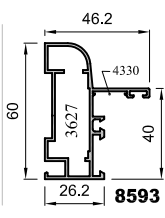
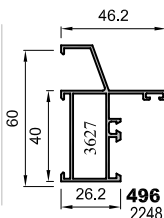
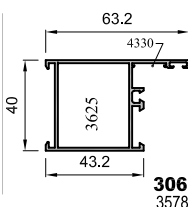
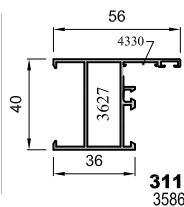
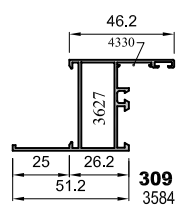
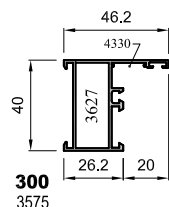



Accesorios

S - 350 EUR



4024
Cremona EURO



4019
Cremona EURO
Os-Ba

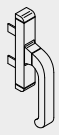

4200
Cremona
Nova



4316
Bisagra apertura
externa

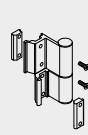

4390
Bisagra regleta
Ø 14 mm.



4724
Bisagra Os-Ba
Simétrica 2º Hoja



4739
Terminal pletina
metálico



4840
KIT Pasadores
hoja pasiva metal.
(sup. e inf.)



4025
Kit Cremona
EURO



4010
Bisagra compás
corto ralenti



4085
Bisagra compás
largo ralenti



4846
Tercer punto
de cierre



4710
Escuadra
alineamien.
14 mm.



4735
Escuadra
alineamien.
2 mm.



4330
Escuadra
alineam. 15



3627
Escuadra
pulsante desc.



3625
Escuadra
pulsante Puerta

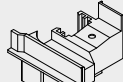

3615
Juego tapajuntas
acople



3601
Taco pilastra
ventana



3600
Taco pilastra
Portada



4313
Taco pilastra
ancha



4324
Junta
central



3016
Junta Burbuja
aximetrica



4008
Patín apoyo hoja



5002
Cierre suplem.
entre hojas



4720
Cerradero lateral
doble pletina
Zamak



4842
Cerradero sup.
regulable OS-BA



4337
Embelle. salida
agua
c/ membrana



4833
Cremona
practicable cover



4834
Cremona os-ba
Cover



4725
Cremona Prima
Os-Ba

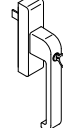

4096
Cremona Os-Pa
con llave

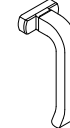

4398
Manilla
recuperable

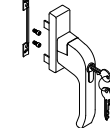

4707
Cremona EURO
c/ llave



4723
Cremona Prima

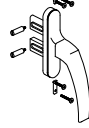

1034
Cremona ap. Ext.
patillas Balcon.

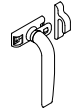

1044
Cierre presión
(Pequeño)



4727
Bisagra Flash
Izquierda/Derecha

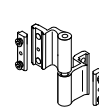

4768
Bisagra
3º Hoja

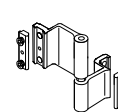

4769
Bisagra Extremo
"Jirafa"



4352
Bisagra ventana
3 hojas

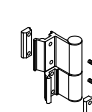

4389
Bisagra regleta
Ø 16 mm.



4744
Bisagra Puerta
24,5 mm. Izda.

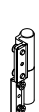

4745
Bisagra Puerta
24,5 mm. Dcha.

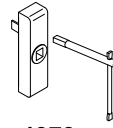

4079
Kit Cremona desmont.
Os-Pa > 2000 mm.

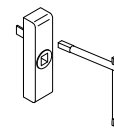

4365
Kit cremona desmont.
OS-PA < 2000 mm.



4002
Pasador oculto
long. variable



4003
Terminal de
pletina cremona

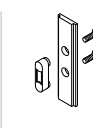

4007
Cierre complem.
cremona

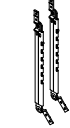

4011
Bisagra compás regul.
proyectante

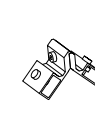

1237
Escuadra pivotes
ventana (An)



1238
Escuadra Europea
Puerta (An)



3622
Escuadra pivotes
hoja ventana



3623
Escuadra europea
ventana



3624
Escuadra
europea Puerta



3626
Escuadra puls.
ventana

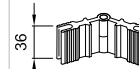

1224
Escuadra ángulo
variable



4039
Escuadra inox.
alineamiento



4304
Escuadra
alineam. solapas



4855
Escuadra solapa
8893



4754
Retenedor
de hoja



4848
Microventilacion
practicable



5026
Bulón regulable



4005
Cerradero lateral
pletina Nylon



4004
Cerradero lateral
doble pletina Nylon



4078
Pieza sujeción
junquillo curvo



4391
Escuadra
junquillos curvos

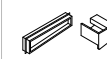

4043
Juego tapas
condensación



4035
Embellecedor
salida agua



4325
Junta central
"TC"



4055
Junta perim.
hoja



4056
Junta perimetral
hoja "TC"



4397
Junta Stilo
base rígida



4379
Junta acústica
cerco



4303
Junta acústica
cerco



4741
Goma para
batiente



4009
Cierre cangrejo
Interno



4366
Cierre bisagra
oculta



4057
Goma exterior
acristalamiento



4089
Goma interior
acrist. de 2 a 4
mm.



4090
Goma interior
acrist. de 4 a 6
mm.



4091
Goma Interior
acrist. de 6 a 8
mm.



4353
Kit acristalam.
s/junquillo vent.



4375
Kit acristalam.
s/junquillo bale.



4356
Broca doble diámetro
(s/junquillo)

Accesorios Varios

- 3610 Juego fresas S-350 EUR
- 3062 Util general S-350 EUR
- 4841 Util General STILO
- 4201 Kit Cremona Nova
- 4025 Kit Cremona EURO
- 4380 Kit Cremona EURO 2 hojas (s/cremona)
4002x2 + 4003x2 + 4025 + 4004x2 + 4008
- 4714 Kit Cremona EURO 1 hoja
4003x2 + 4025 + 4005x2
- 4334 Tijeras ingleses goma
- 4335 Ruleta para goma
- 1161 Patillas
- 4098,4099,4357
- 4373,4374,4758 Cerraduras ST-50 RPT
- 4862 Cerradura Apertura externa
- 5022 Cremona Industrial Prima
- 5023 Cremona Industrial Euro
- 5024 Herraje Os-Ba Industrial

Perfiles

S - 350 EUR Mallorca

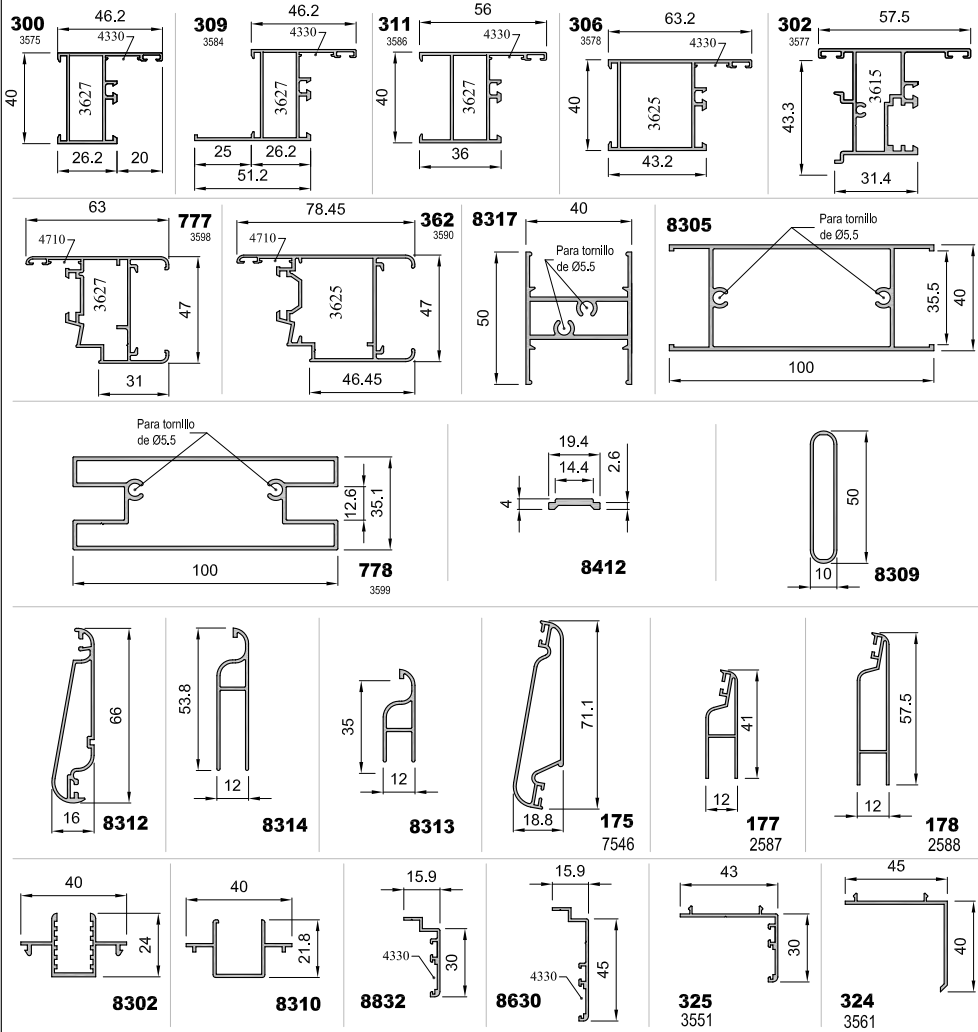

Accesorios

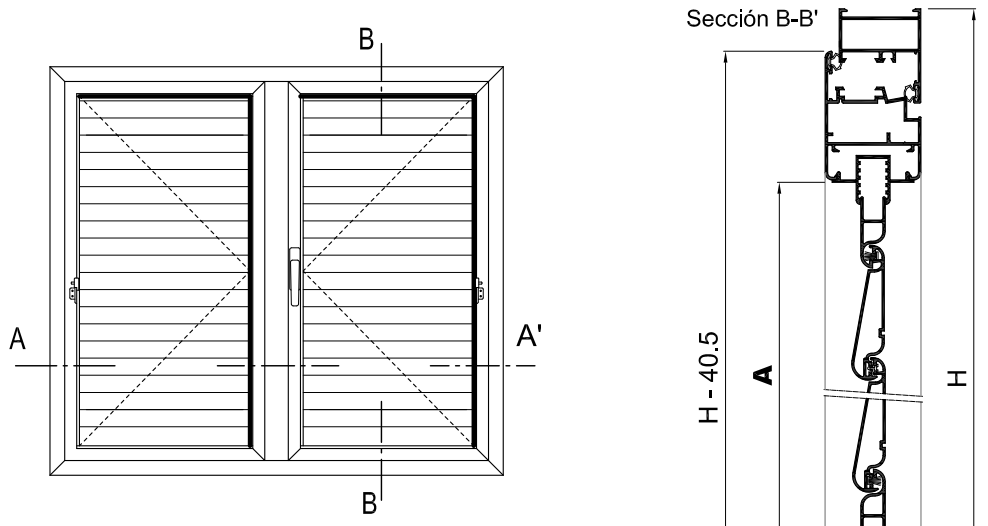
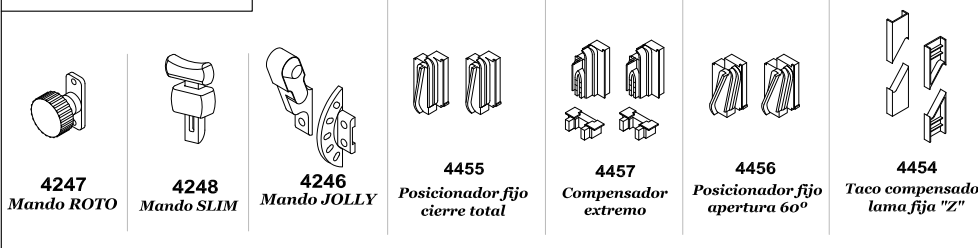

VENTANA 2 HOJAS MALLORQUINAS

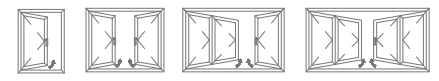

Posibilidades de Apertura

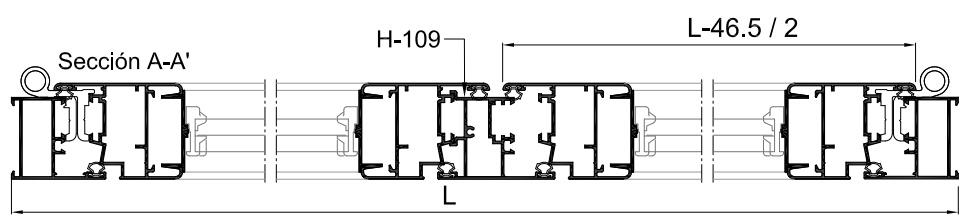

Ver Instrucciones de Montaje de las Celosías al final de serie Mallorca Corredera

TABLA DE CELOSÍAS					
REF.	Nº DE LAMAS	* A (mm.)	REF.	Nº DE LAMAS	* A (mm.)
4209	UN55 6 LAMAS	387 - 441	4224	UN55 21 LAMAS	1212 - 1266
4210	UN55 7 LAMAS	442 - 496	4225	UN55 22 LAMAS	1267 - 1321
4211	UN55 8 LAMAS	497 - 551	4226	UN55 23 LAMAS	1322 - 1376
4212	UN55 9 LAMAS	552 - 606	4227	UN55 24 LAMAS	1377 - 1431
4213	UN55 10 LAMAS	607 - 661	4228	UN55 25 LAMAS	1432 - 1486
4214	UN55 11 LAMAS	662 - 716	4229	UN55 26 LAMAS	1487 - 1541
4215	UN55 12 LAMAS	717 - 771	4230	UN55 27 LAMAS	1542 - 1596
4216	UN55 13 LAMAS	772 - 826	4231	UN55 28 LAMAS	1597 - 1651
4217	UN55 14 LAMAS	827 - 881	4232	UN55 29 LAMAS	1652 - 1706
4218	UN55 15 LAMAS	882 - 936	4233	UN55 30 LAMAS	1707 - 1761
4219	UN55 16 LAMAS	937 - 991	4234	UN55 31 LAMAS	1762 - 1816
4220	UN55 17 LAMAS	992 - 1046	4235	UN55 32 LAMAS	1817 - 1871
4221	UN55 18 LAMAS	1047 - 1101		UN55 33 LAMAS	1872 - 1926
4222	UN55 19 LAMAS	1102 - 1156			
4223	UN55 20 LAMAS	1157 - 1211			

* Altura libre de hueco de hoja